

INTERURBAN MODELS

HO
scale
1:87

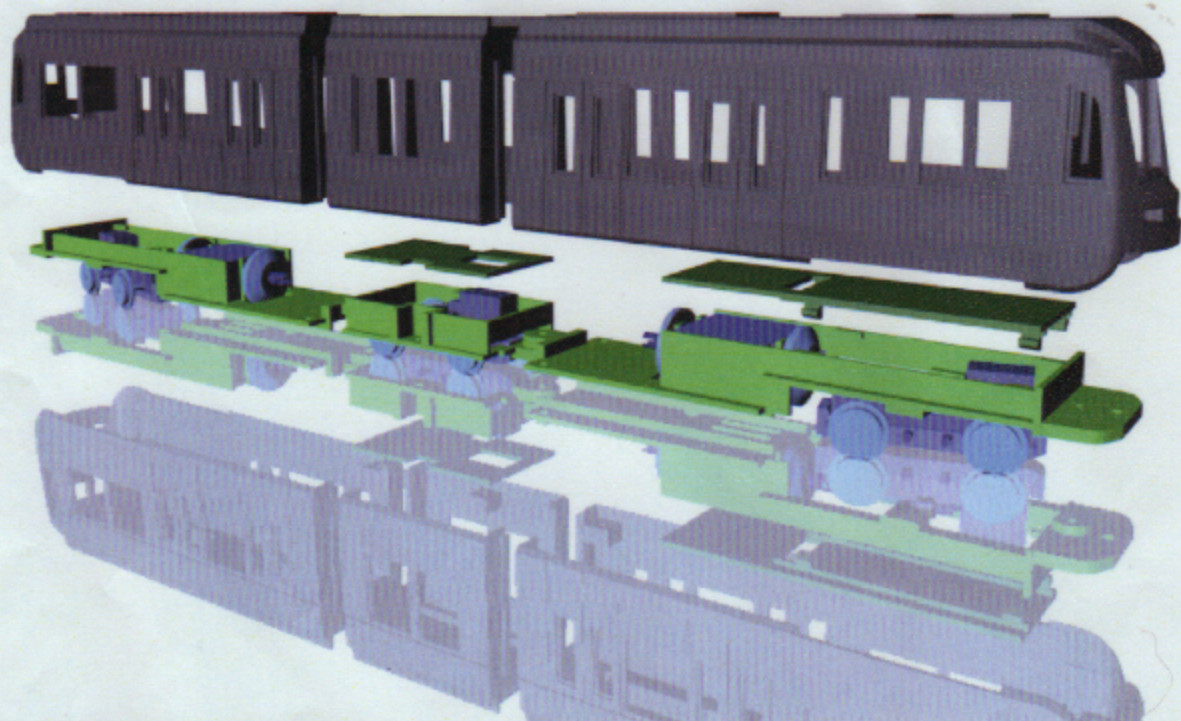

SIEMENS S70 «ULTRASHORT» LRV



Salt Lake City

In 2010 Siemens introduced the latest edition of light rail vehicles, the 70% low floor Siemens S70 Ultra Short light rail vehicle. Each six-axle S70 Ultra Short light rail vehicle is equipped with two power trucks and a non-powered centre truck

The S70 LRV operates at speeds up to 55 mph, carrying close to 230 passengers in each vehicle with the ability to operate in multiple vehicle up to



San Diego

Prototype Vehicle Dimensions and Weight

Length over coupler	81.4 ft	24810 mm
Width	8.7 ft	2650 mm
Height, pantograph down	12.3 ft	43771 mm
Max. pantograph height	up to 23 ft	7000 mm
Vehicle empty weight	96,500 lbs	43771 kg
High floor section	2.8 ft	855 mm
Low floor section	1.2 ft	356 mm
Minimum turning radius	82 ft	25 m
Vertical curve, crest	820 ft	250 m
Vertical curve, sag	1150 ft	350 m
Track gauge	4.7 ft	1435 mm
Wheel base	6.2 ft (power trucks)	1900 mm
	5.9 ft (center truck)	1800 mm

shapeways* coming soon ...



Atlanta